

# TSL-20

## 2-3/4" TOP SIDE LOCATOR

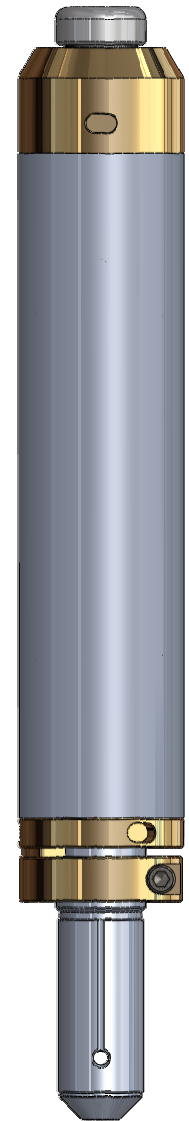

### Description

The DSS 2 3/4" TSL-20 is used with the DSS HSR bond tools to produce an angular output from the bond tool which can be used to display which radial receiver is on the top side of the tool while logging deviated or horizontal wells. It is connected below the bottom centralizer and aligned to the number one radial receiver prior to logging. It can only be used on the bottom of DSS HSR bond tools.

### Applications

- Indicate which radial receiver is on the top side of the bond tool.

### Features

- Rated for high-temperature and high-pressure environments.
- Simple to add to DSS HSR bond tools.
- Compatible with surface systems that can run DSS HSR bond tools.
- Electronic design verified for 1 hour operation at 415°F to ensure reliability.
- Sour service compatible materials.
- No internal calibration required.

### Specifications

<b>Angular Accuracy</b>	<b>+/- 1 Degrees</b>	<b>Tool Length (make-up)</b>	<b>45.05 cm (17.74 in)</b>
<b>Minimum Deviation Angle</b>	<b>15 Degrees</b>	<b>Tool Length (shipping)</b>	<b>46.76 cm (18.41 in)</b>
<b>Max. Pressure</b>	<b>172.4 Mpa (25,000 PSI)</b>	<b>Tool Weight</b>	<b>9.03 Kg (17.9 Lb)</b>
<b>Max. Temperature</b>	<b>204°C (400°F)</b>	<b>Borehole Fluids</b>	<b>Oil - Fresh Water - Brine</b>
<b>Tool Diameter - OD</b>	<b>69.85 mm(2-3/4 in)</b>	<b>Top End Connector</b>	<b>Contact Socket Go Female</b>



### **Downhole Sonic Solutions Inc.**

170, 5255 McCall Way N.E.  
 Calgary, AB, T2E 7J5, Canada  
 Phone : +1 403-219-2108  
 Fax : +1 403-219-2106

[www.dsstools.com](http://www.dsstools.com)  
[sales@dsstools.com](mailto:sales@dsstools.com)